

How To Setup MetaMask Wallet on Your Mobile Device

1. Go to AppStore -> Search for “Metamask”

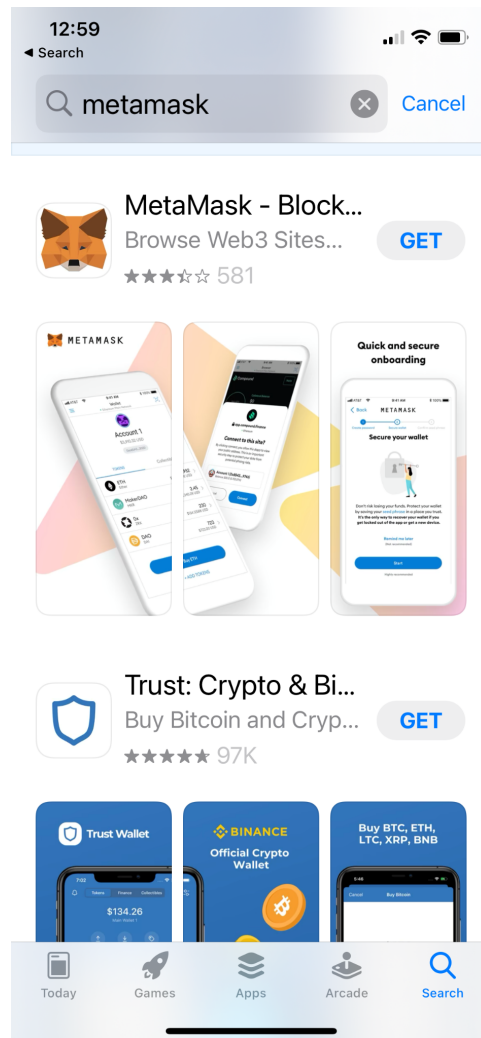

MetaMask Download Links:

U.S.-based Users:

iOS: <https://apps.apple.com/us/app/metamask/id1438144202>

Android: https://play.google.com/store/apps/details?id=io.metamask&hl=en_US

China-based Users:

iOS: <https://apps.apple.com/us/app/metamask/id1438144202>

Android: <https://en.softonic.com/download/metamask/android/post-download>

2. Click “Get” on “MetaMask - Blockchain Wallet” to download App

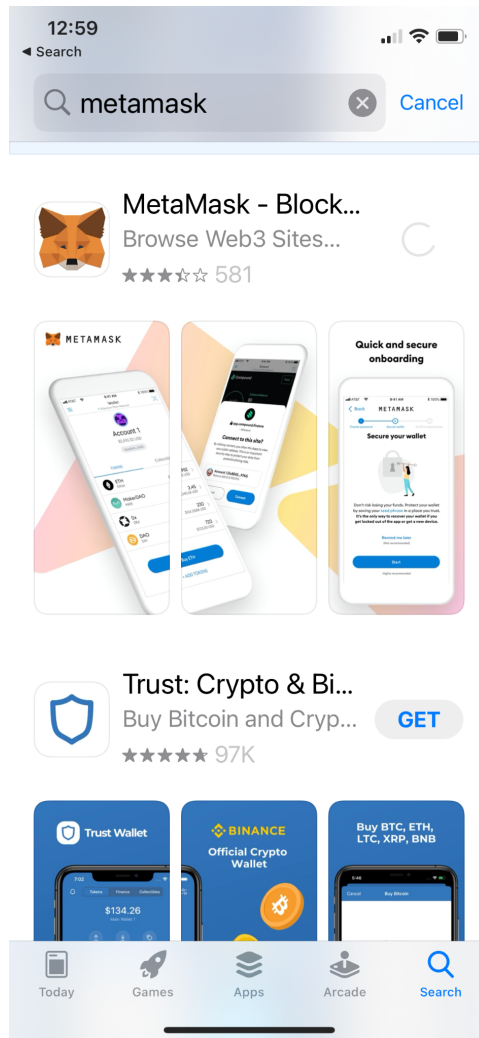

3. After App download completes, open app -> click “Get Started”

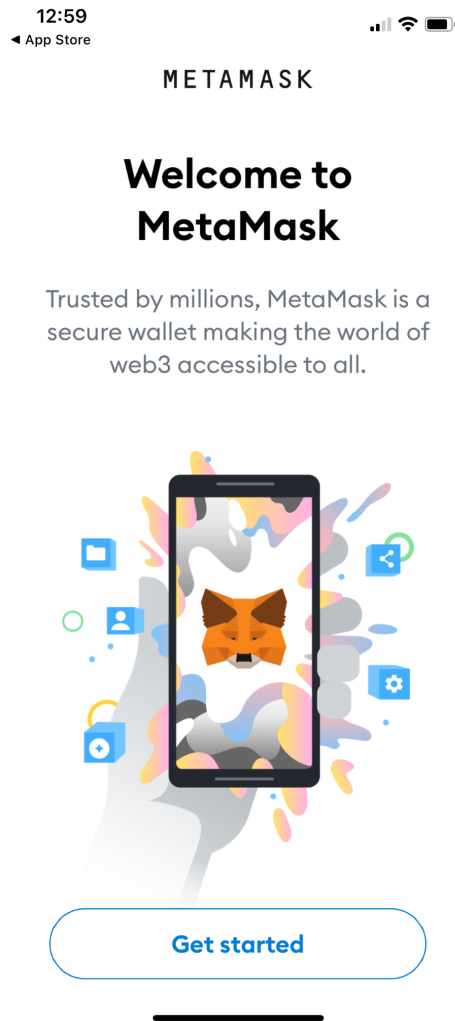

4. Select “Create a New Wallet”

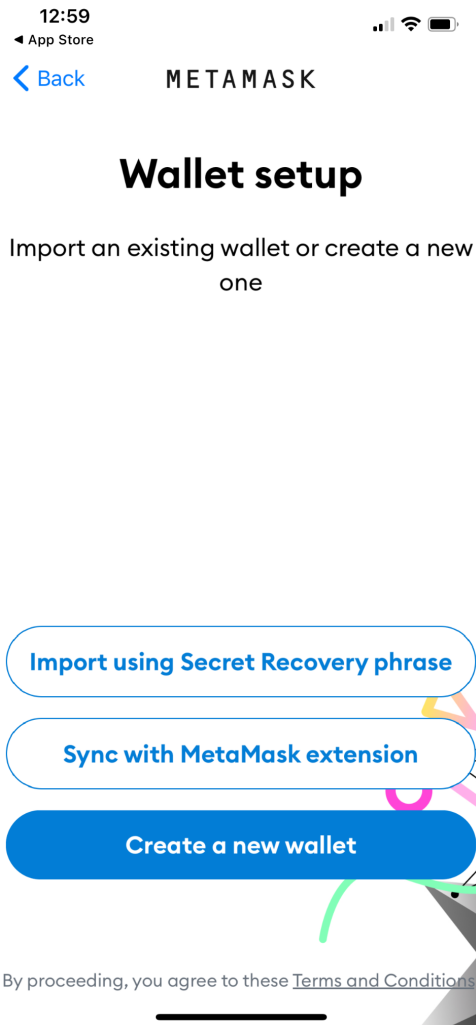

5. Create a new password based on specified criteria and Confirm Password

12:59

App Store

METAMASK

1

2

3

Create passwordSecure walletConfirm Secret Recovery phrase

Create password

This password will unlock your MetaMask wallet only on this device.

New Password

Show

Confirm password

Must be at least 8 characters

Sign in with Face ID?

I

☐

I understand that MetaMask cannot recover this password for me. [Learn more.](#)

6. Once password is confirmed and qualified -> enable Face ID if you'd like and check and agree "I understand password cannot be recovered "

13:00

◀ App Store

METAMASK

1

2

3

Create passwordSecure walletConfirm Secret Recovery phrase

New Password

Show

Password strenath: Good

Confirm password

Must be at least 8 characters

Sign in with Face ID?

☒

☐ I understand that MetaMask cannot recover this password for me. [Learn more.](#)

Create password

7. Click “OK” to enable Face ID authentication

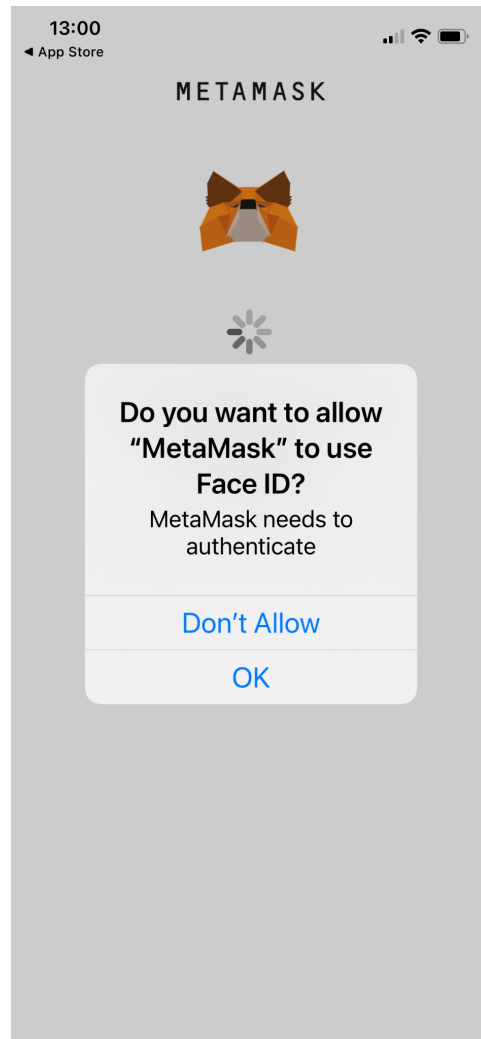

8. Proceed to Securing Wallet step

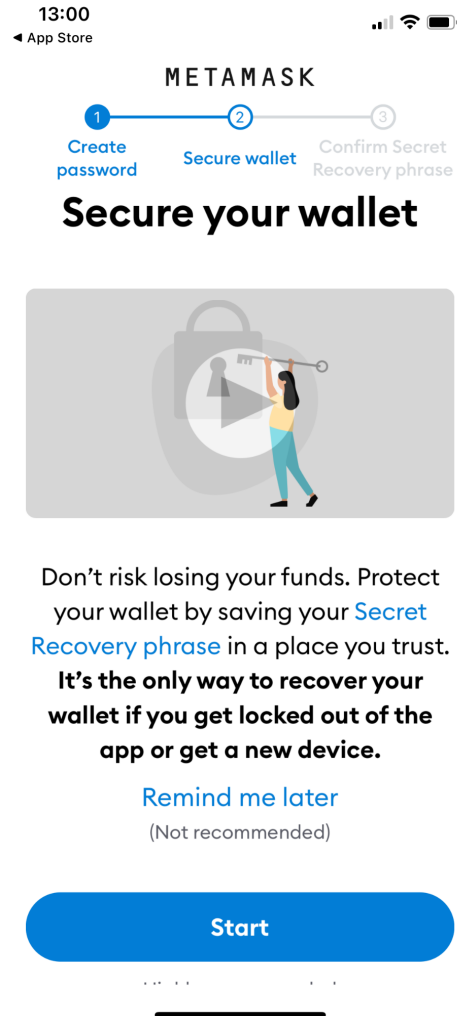

9. Review the precautions of securing your wallet -> click “Start”

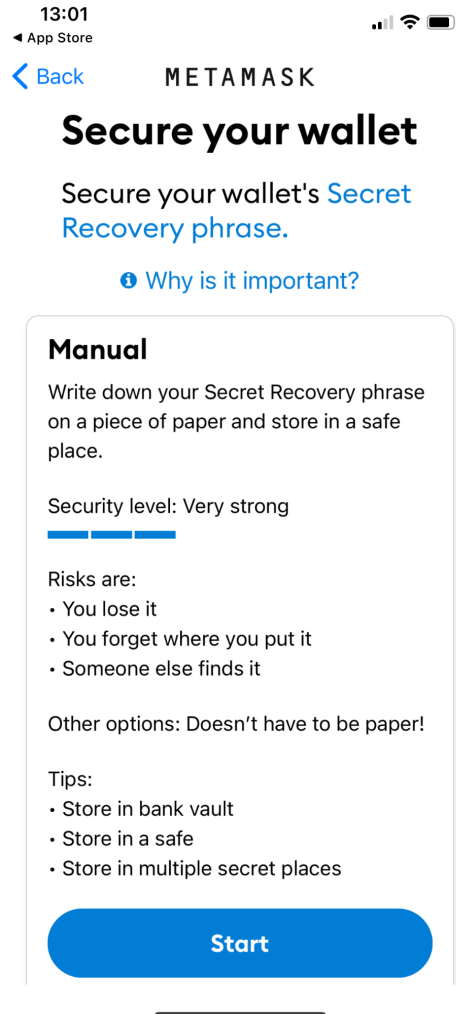

10. Write down the 12 seed phrase words on a piece of paper

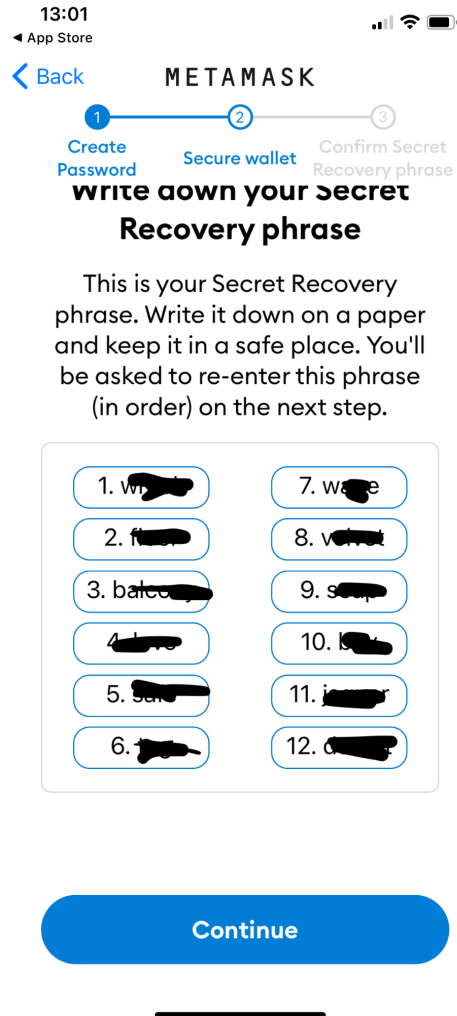

11. Confirm the 12 seed word phrase by re-entering them in the correct order

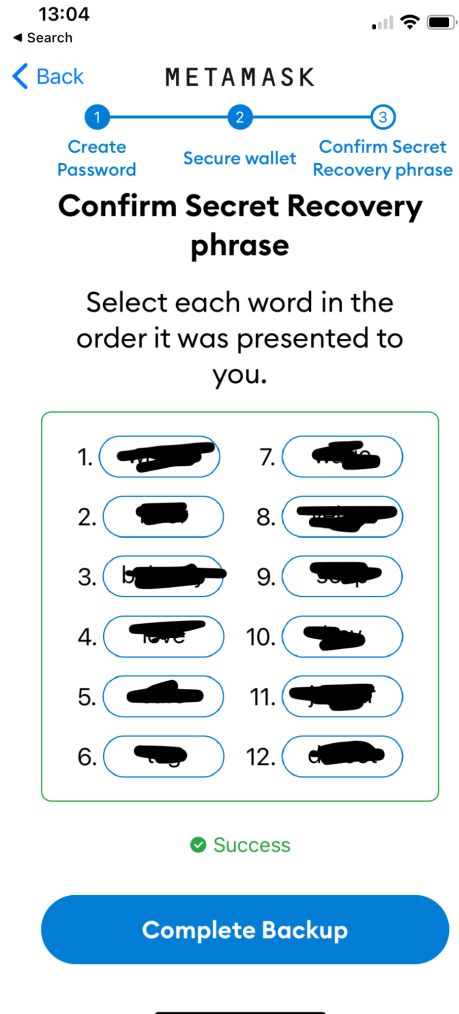

12. Congratulations ! Account created successfully ! -> click Done



13. Skip the tutorial prompt -> Enter your wallet app

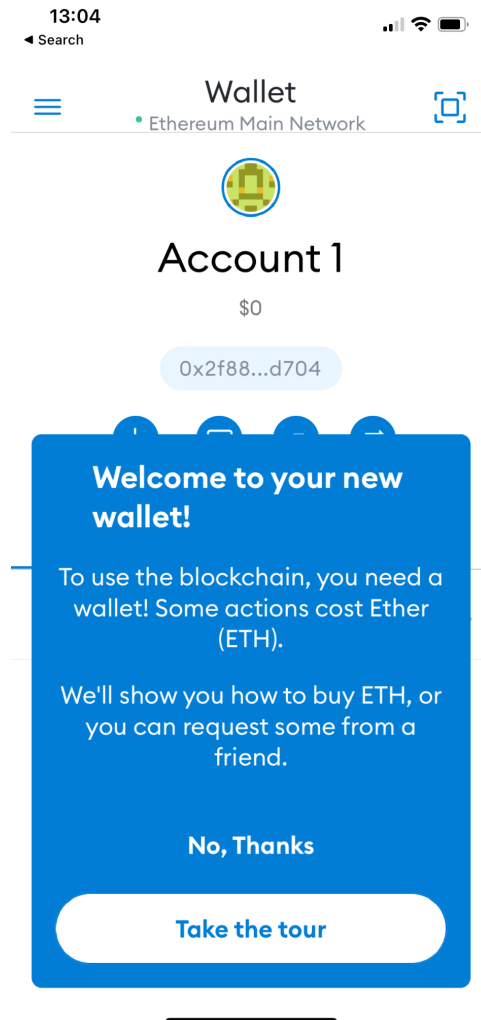

14. Your newly created account is shown below -> copy and paste your wallet public address "0x...." to share with others

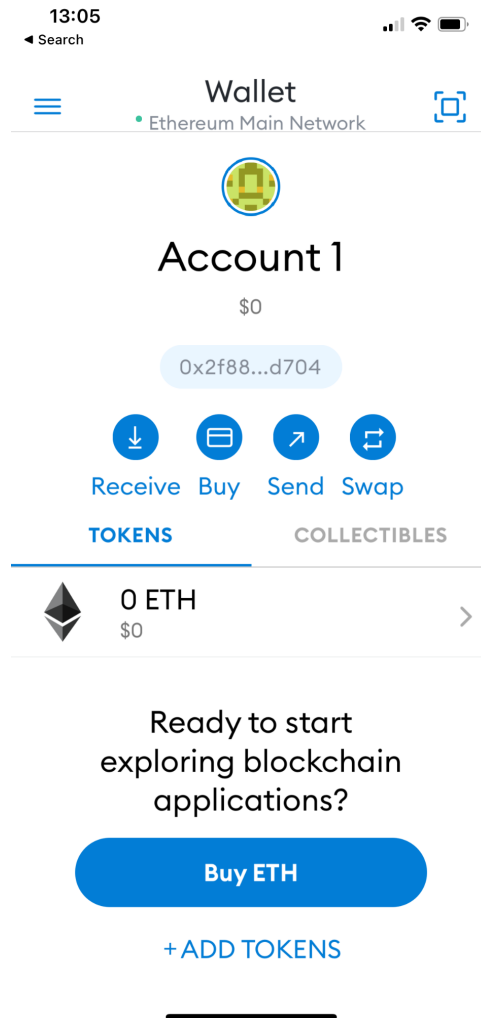

****How To Switch from Ethereum Network to Polygon Matic Network****

- 1. From Homepage -> Click Left Top Menu icon -> Click “ Settings “ -> From Settings menu, click “ Networks ” to add a custom network**

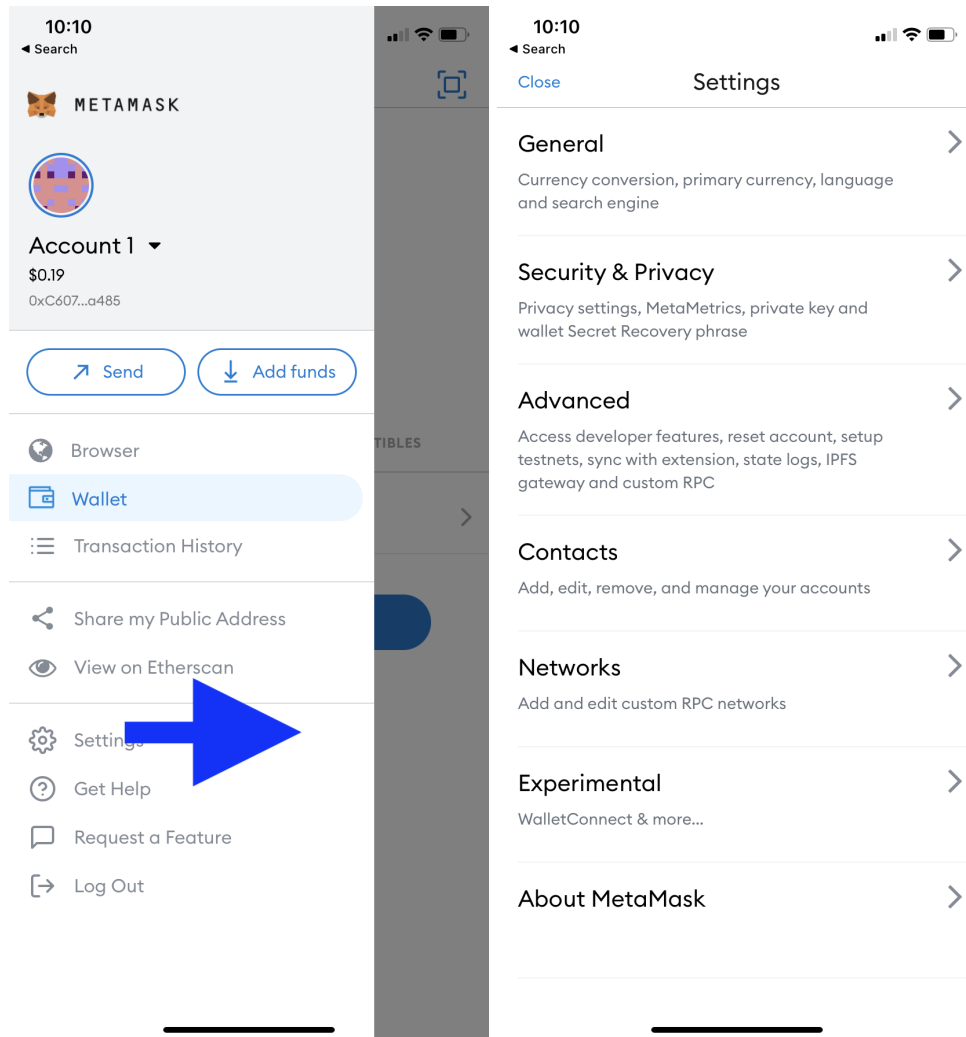

2. Click “Add Network “

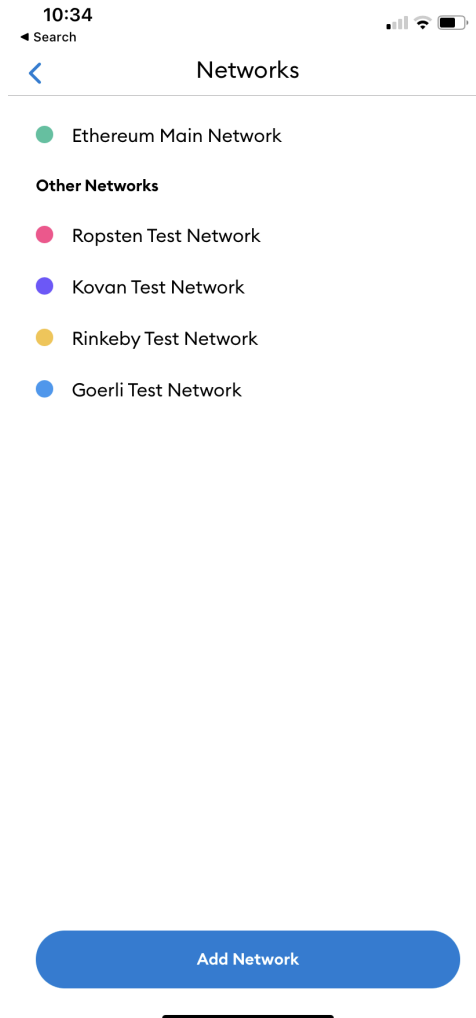

3. Enter the following information, and click “Add” in order to add Polygon network:

Network Name = “ MATIC Mainnet “
RPC Url = “ <https://rpc-mainnet.maticvigil.com> “
Chain ID = “ 137 “
Symbol = “ MATIC “
Block Explorer URL = “ <https://polygonscan.com> “

10:26
Search

Networks

Network Name

MATIC Mainnet

RPC Url

https://rpc-mainnet.maticvigil.com

Chain ID

137

Symbol

MATIC

Block Explorer URL

https://polygonscan.com

Add

1 2 3 4 5 6 7 8 9 0
- / : ; () \$ & @ "
#+= . , ? ! ' <X>
ABC space return
Globe Microphone

4. Newly added “ Matic Mainnet” will be shown on the Network List -> select and click “Add Network”

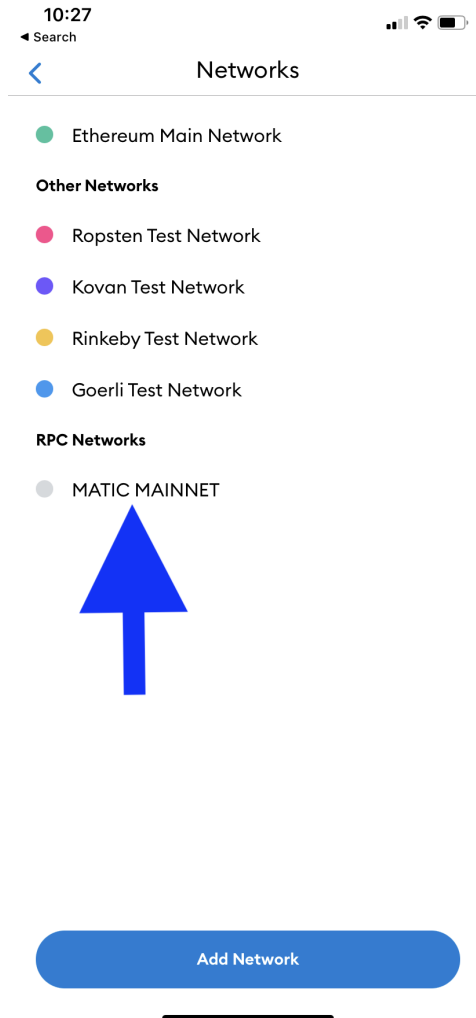

5. Exit to Wallet Homepage -> click on “Wallet” in title bar to expand Network List -> select “MATIC Mainnet” as the Network. You have now successfully switched to MATIC network !

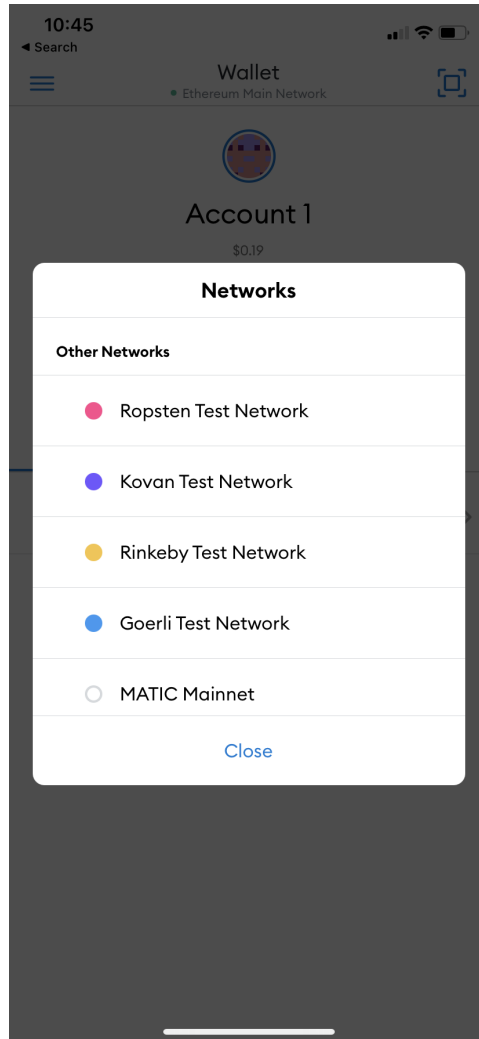

****How To Import Your CNFT Wallet account ****

- 1. Login to your CNFT.us account -> From top right click “My Wallet “ dropdown -> click “My Settings “**

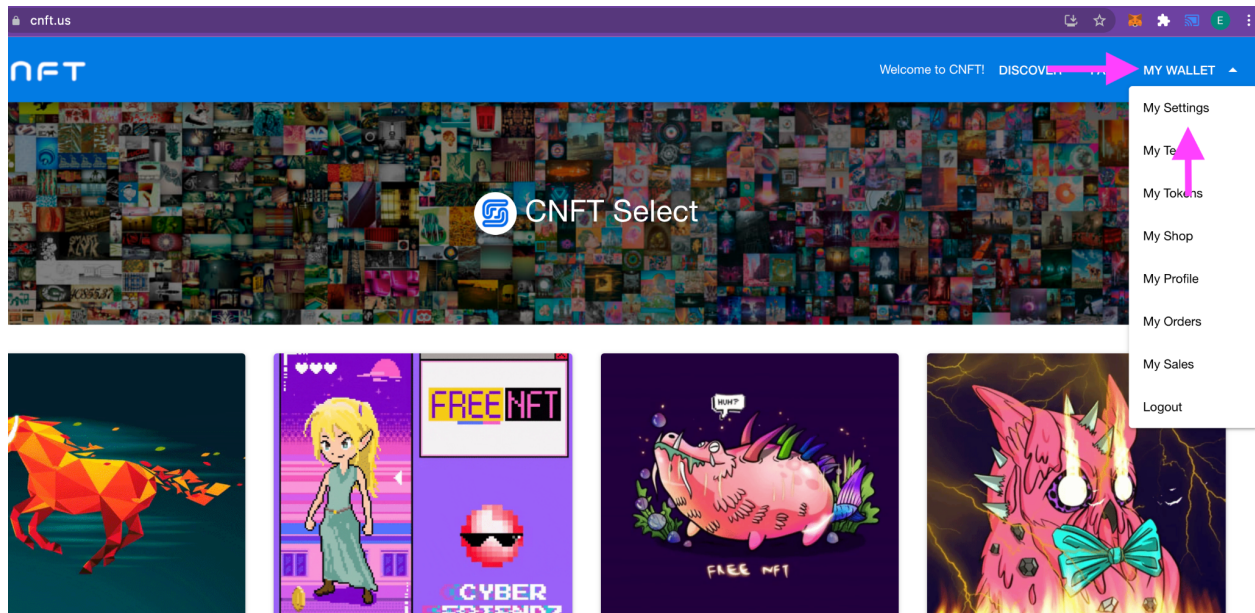

2. Scroll down to find your Wallet address and Private Key -> Copy and Save both to a secure location

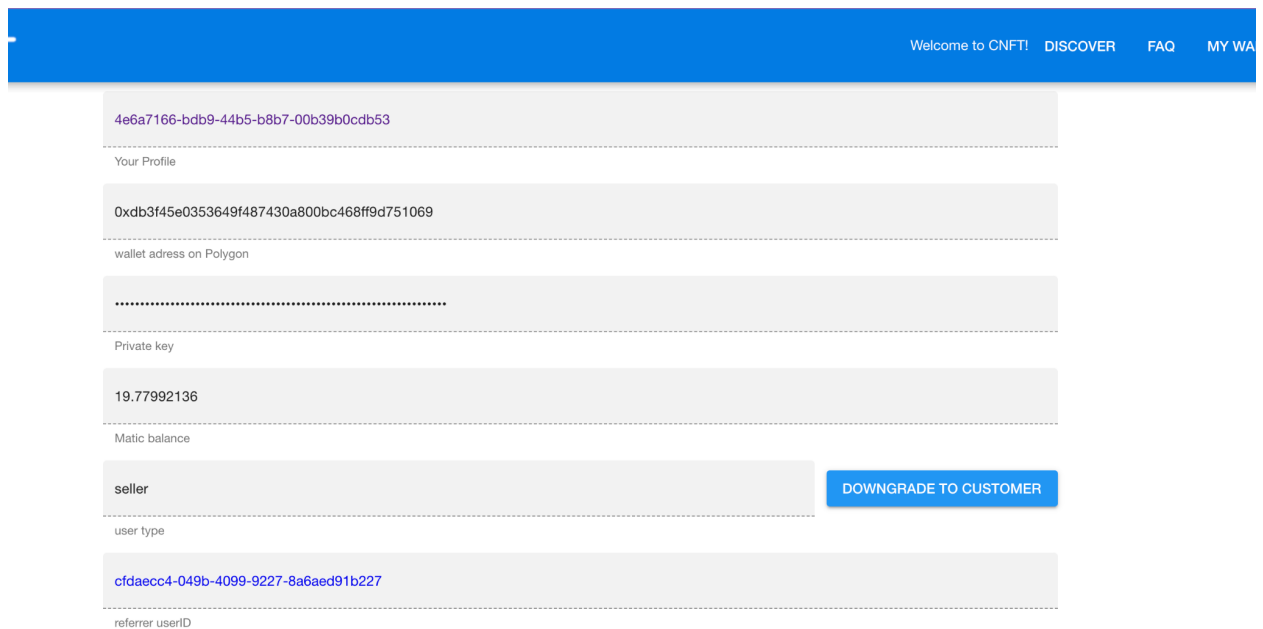

- 3. Return to your MetaMask app -> Click Icon above Account Name to expose Account selection popup window -> click "Import Account" -> Here enter the privateKey you have just saved -> Double check privateKey entered correctly and click "Import"**

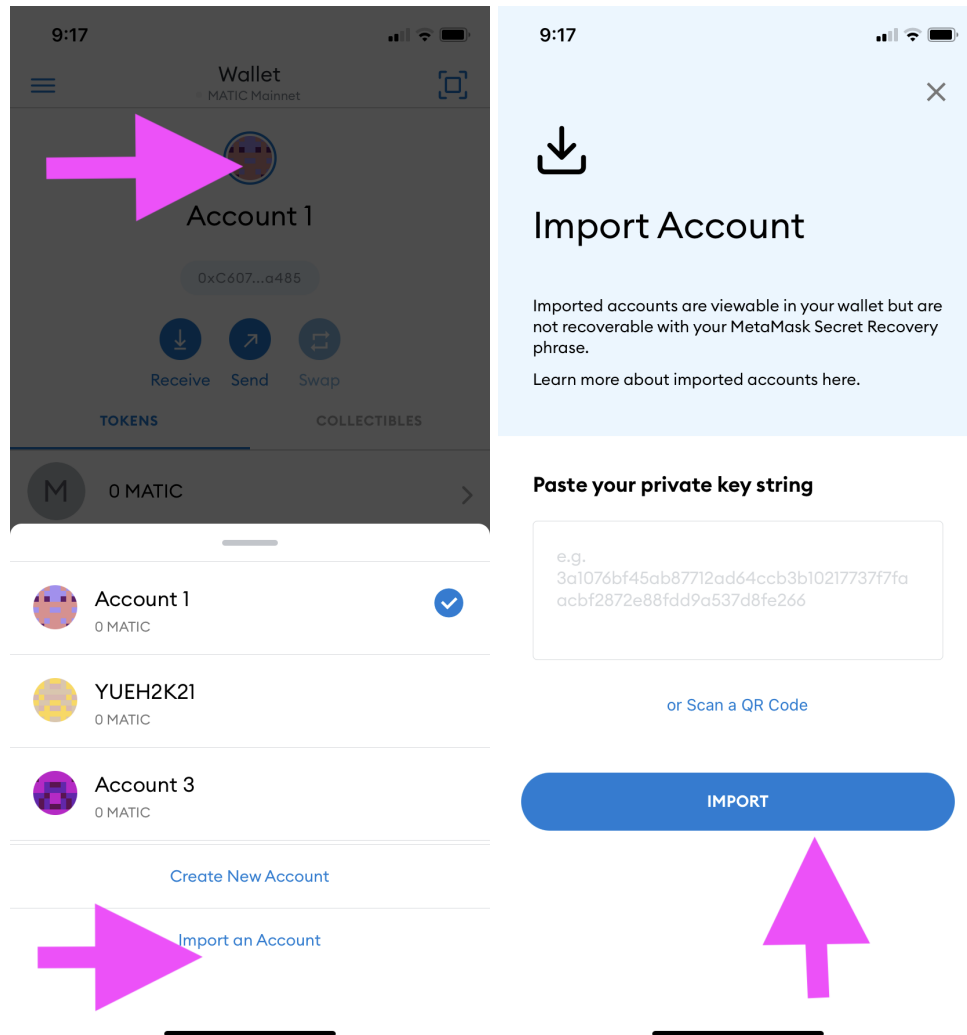

4. Now You have successfully imported your CNFT Matic Wallet account on your MetaMask Wallet -> Long-Click on the default Account Name area, in order to edit and update to a custom accountName

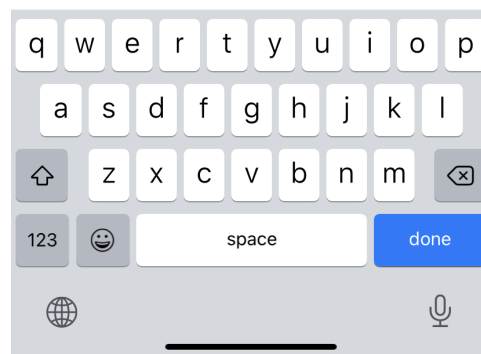
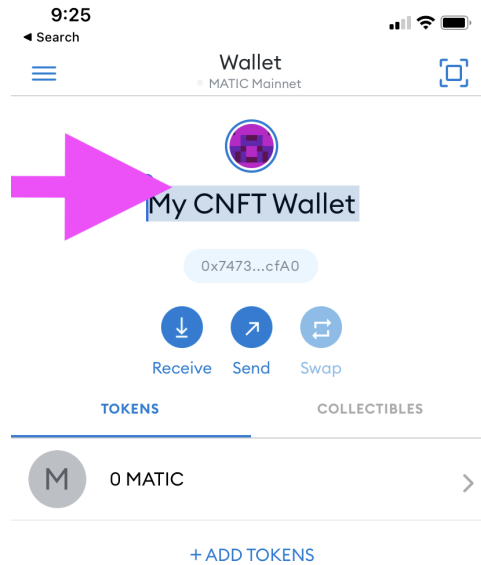

****How to Add and Display your CNFTG Token ****

- 1. Click “+ Add Tokens”**

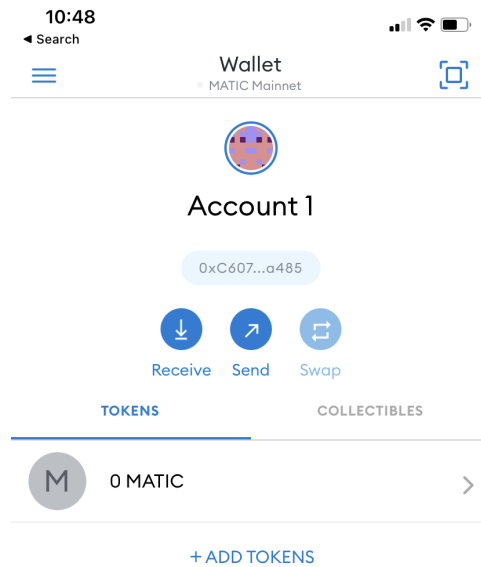

2. Enter Contract Address below in the “Token Address” field:

0x52A3FCb9D0a62Eb507F3f9B4Fa30d35cE03E6df8

If entered correctly, Token Symbol and Token Precision will be automatically shown:

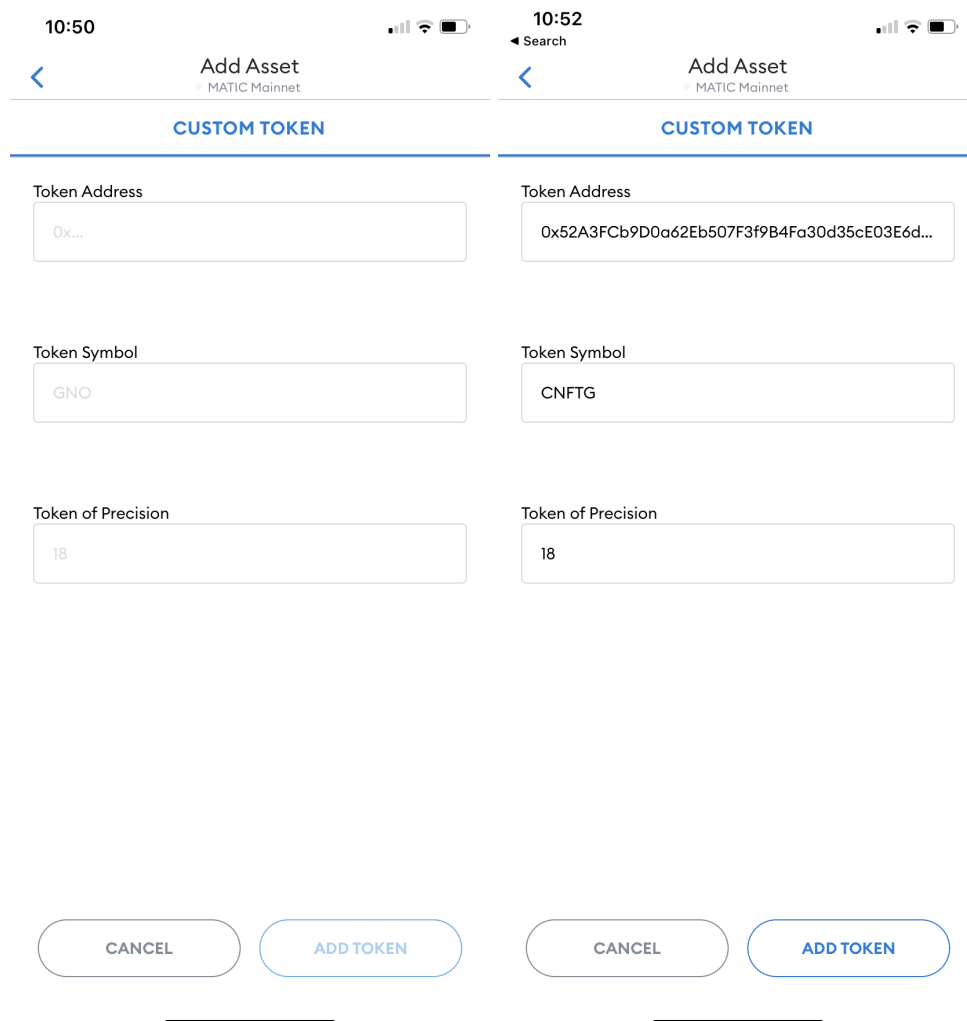

3. Now click “Add Token”

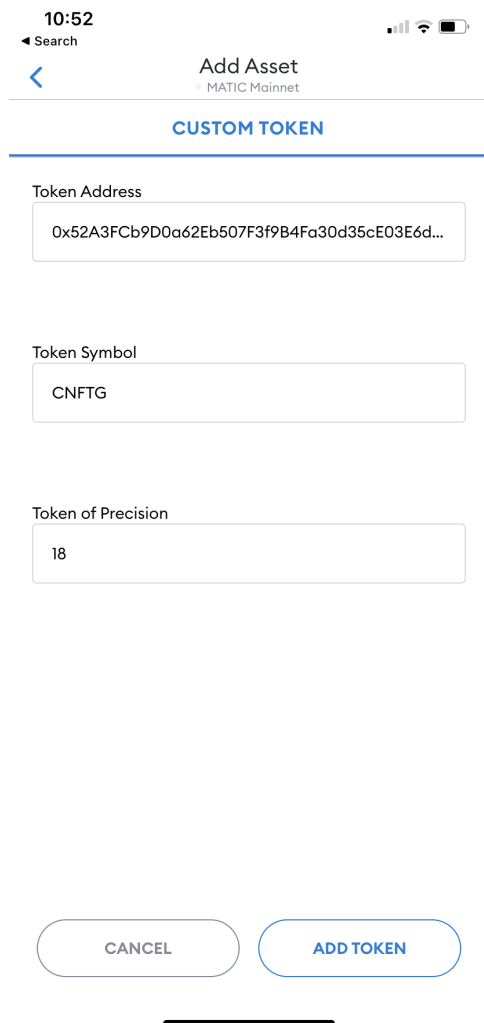

4. There! Your CNFTG Token is now listed on your Wallet !

10:56

Search

Wallet

MATIC Mainnet

Account 1

0xC607...a485

Receive

Send

Swap

TOKENS

COLLECTIBLES

M

0 MATIC

>

0 CNFTG

>

+ ADD TOKENS

